



Operation & Service Manual

Pressure Relief Valve Model 46

REVISION: 202403

MANUAL VALVE OPENING PRESSURE ADJUSTMENT

Although the valve may be adjusted while fluid is flowing through the valve, express caution should be used. Unscrew nut (12), when applicable, and sleeve (10). Loosen lock ring (15). Turn adjusting nut (16) to change opening pressure. Tighten lock ring (15) when desired opening pressure is reached. Screw on both sleeve (10) and then nut (12) hand tight.

VALVE SERVICE

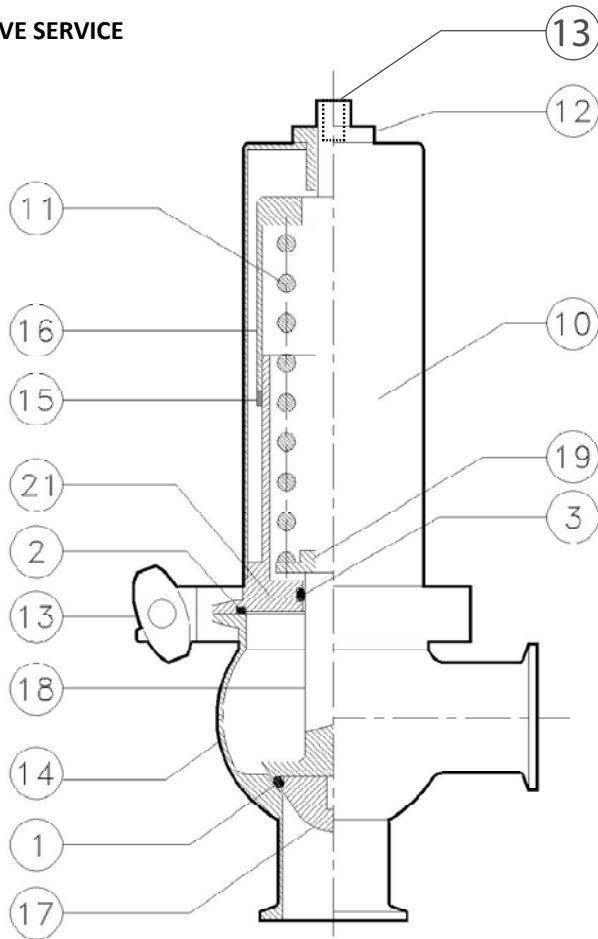

MANUAL ADJUSTABLE VALVE

Depressurize the system the valve is operating in. Isolate the valve by removing fluid from the system or isolate it by closing valves on both sides. Remove the Pressure Relief Valve from the system.

BREAKDOWN:

Unscrew nut (12), when applicable, and sleeve (10). Mark position of lock ring (15) with permanent marker. Do not damage threads. Loosen lock ring (15). Unscrew adjusting nut (16) so that spring (11) is exposed. Remove clamp (13). Separate valve body (14). O-ring (2) is now exposed and may be replaced. Pull out stem (18). O-ring (3) is now exposed and may be replaced. Place the stem in a vise and unscrew cap (17). O-Ring (1) is now exposed and may be replaced.

ASSEMBLY:

While stem is in vise, screw cap (17) onto stem (18), hand tight. Roll o-ring (1) into place and tighten cap with wrench. Slide stem into stem guide (21). Attach valve body (14) to stem guide (21) with clamp (13). Slide washer (19) onto stem, flat side down. Slide spring (11) onto washer (19). If it was removed, screw lock ring (15) onto stem guide (21) to position marked previously. Screw on adjusting nut (16). Screw on both sleeve (10) and then nut (12), when applicable, hand tight. Replace valve in system.

MANUAL LIFT ENGAGEMENT

The valve may be opened manually for cleaning or bypass by tightening nut (12) with a wrench. This will lift stem (18). To return stem (18) to its original position, loosen nut (12) until it just lifts off sleeve (10). This feature is not available on the ½" and ¾" size Pressure Relief Valves.

PNEUMATIC LIFT ENGAGEMENT (Model #46A only)

Apply air pressure to the air override connection (13) located at the top of the stem (18).

USE CAUTION. VALVES ARE SPRING LOADED. UNIBLOC HYGIENIC TECHNOLOGIES assumes no responsibility for damage or injury incurred while adjusting or servicing the #46 Pressure Relief Valve. These valves are not ASME coded.

Setting the #46 Pressure Relief Valve

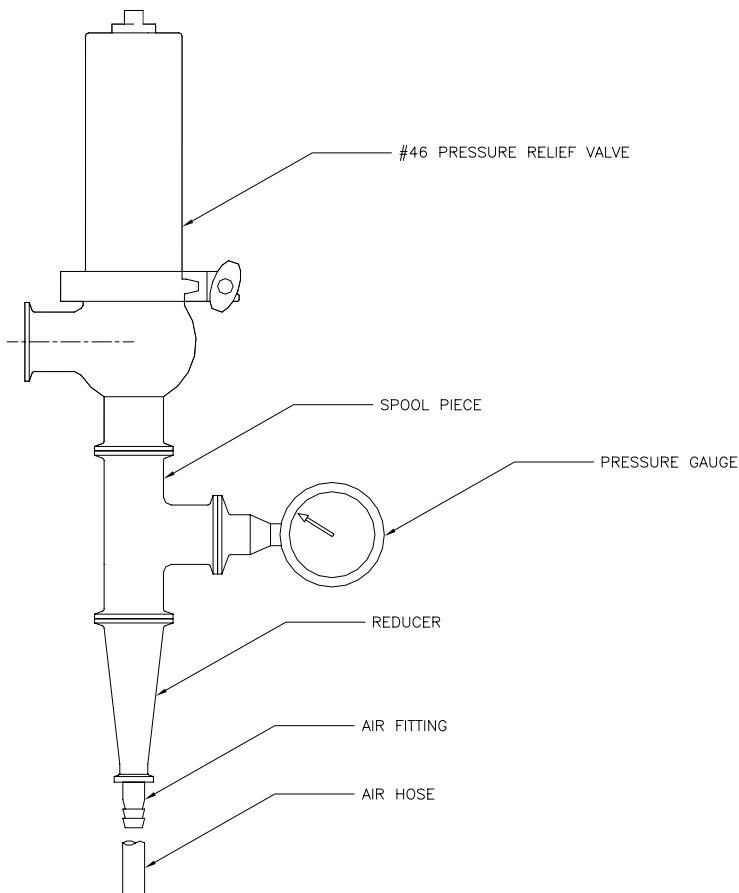

The following pieces will be required to adjust pressure:

- #46 Pressure Relief Valve
- T-Spool Piece
- Calibrated Pressure Gauge
- Reducer (depends on size of valve and size air tubing available)
- Air fitting
- Air hose connected to air supply

1. Assemble apparatus as shown to the left. Be sure to tighten all clamp connections.
2. Adjust air supply (compressor) to desired pressure setting.
3. Connect air hose to air fitting.
4. If air passes through the valve, remove air hose.
5. Tighten adjustment nut (#16 from Valve Manual) by turning clock-wise to compress spring.
6. Repeat step 3-5 once air does not pass valve. Proceed to step 7.
7. If air does not pass through valve, turn adjustment nut (16) counter clock-wise until just after pressure is relieved.
8. Turn locking ring (#15 from Valve Manual) to lock pressure setting.
9. Dis-Assemble apparatus.

WARRANTY

Unibloc Hygienic Technologies, LLC ("Unibloc") warrants that its product will be free from defects in material and workmanship which results in noncompliance with the Specifications for such product. This warranty shall begin upon delivery and continue for a period of one (1) year from such date. If during this period the product does not comply with its specifications as a result of defects in material or workmanship, contact Unibloc to arrange return of the faulty product, shipping prepaid and fully insured, to an authorized Unibloc service facility. If upon inspection of the item in question, defects in workmanship or materials are revealed, Unibloc's sole obligation under this warranty shall be to supply a repair or replacement for any defective part of a product, and to return such product to the customer by shipping it EX WORKS (as defined in Incoterms 2020) the service facility. Unibloc shall not be required to supply any labor for repairs or replacement of parts. This warranty is void if the product has not been used as recommended or instructed, has been altered or used with unauthorized accessories, has been subject to misuse, abuse or accident, or has been damaged due to causes not related to poor workmanship or defective materials. All parts or components not manufactured by Unibloc are warranted only to the extent of the warranty of the respective manufacturers.

THIS LIMITED WARRANTY IS EXPRESSLY GIVEN IN LIEU OF ALL OTHER EXPRESS OR IMPLIED WARRANTIES, INCLUDING BUT NOT LIMITED TO WARRANTIES OF MERCHANTABILITY, FITNESS FOR A PARTICULAR PURPOSE, AND NON-INFRINGEMENT, ALL OF WHICH ARE HEREBY EXCLUDED. IN NO EVENT SHALL UNIBLOC OR ITS AFFILIATES BE LIABLE TO ANYONE FOR SPECIAL, COLLATERAL, INCIDENTAL, OR CONSEQUENTIAL DAMAGES, WHETHER ARISING IN CONTRACT OR IN TORT.

UNIBLOC RESERVES THE RIGHT TO MAKE TECHNICAL CHANGES WITHOUT NOTICE.

Unibloc Hygienic Technologies US, LLC

1650 Airport Rd, Ste 110 • Kennesaw, GA 30144 • USA

Tel 1+770-218-8900 • E-Mail sales@unibloctech.com



unibloctech.com

